

- Extra reinforced aluminium cast body through the heat treatment and industrial design
- Light and powerful design
- %100 Holding Negative-Acting Hydraulic brake system.
- Standard Pressure Roller and Roller Failed.
- Easy assembly, High rope capacity and High torque hydromotor
- Standard manual rope unloading system

Specifications

HMW 5.0 PHT/P Air Clutch
HMW 5.0 PHT Manual Clutch

Max.pulling capacity (kg / lbs)	: 5000 kg (11022)
Max.rope length (mt / ft)	: 45 m (148 ft)
Recommended wire rope (mm / in)	: 12 mm (1/2")
Hydromotor (cc / in³) :	: 315 cc (19 in³)
Max. pump flow (l / min - gal / min)	: 60 lt (15.8 gal)
Gear ratio:	: 5,6 : 1
Oil types and capacity	: 85W 90 - 0,75 lt.
Max. working pressure (bar / psi)	: 165 bar (2392 psi)

Winch : (kg / lbs)

44 kg (96,8 lbs)

Roller Fairlead : (kg / lbs)

6 kg (13,22 lbs)

Cable Tensioner

2,5 kg (5,51 lbs)

Mounting Bolts

8 pieces M14 8,8

Standards

Cable tensioner
Roller Fairlead

Optinal

Air Clutch
IP67 - IP 68

Hydraulic Inlets

G 1/2"

Rope Winding Layer	Pulling Capacity kg / lbs	Rope Speed m / min- ft / min	Rope Length m / ft
1	5000 / 11022	11 / 37	6 / 21
2	4203 / 9264	13 / 44	14 / 46
3	3625 / 7990	15 / 51	23 / 77
4	3187 / 7024	17 / 58	33 / 109
5	2843 / 6267	20 / 65	45 / 148

Warning !!

- Before operate the winch, A-B lines must be open to T line (tank line) of the control valve in center position.
- This winch is desingd and manufactured for pulling, don't lift person or metarial.
- Always keep last 5 wrap on the drum.
- The tecnical details given above just for infarmation. HAMMER WINCH keeps the to change the tecnical. details
- Pneumatic Working Pressure: Min - Max 9 – 12 bar (130 - 174 psi)

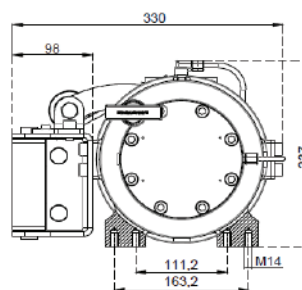
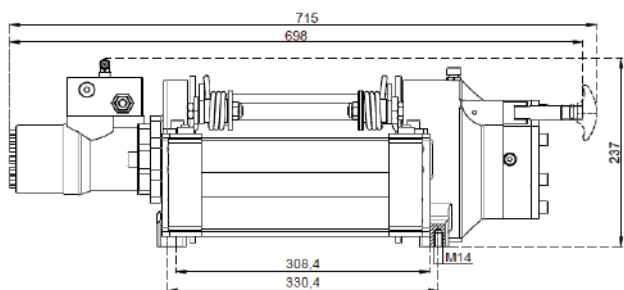

Manual

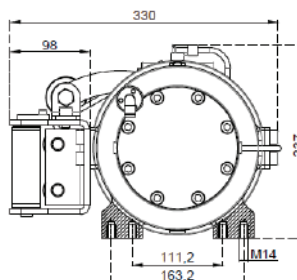
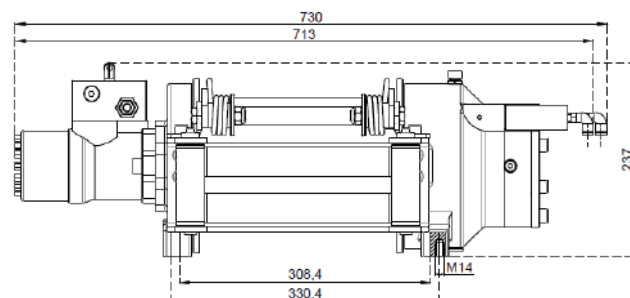

Air Clutch

